

R E C O R D E D A S . . .

The Northeast Wisconsin Chapter of the Wisconsin Society of Land Surveyors

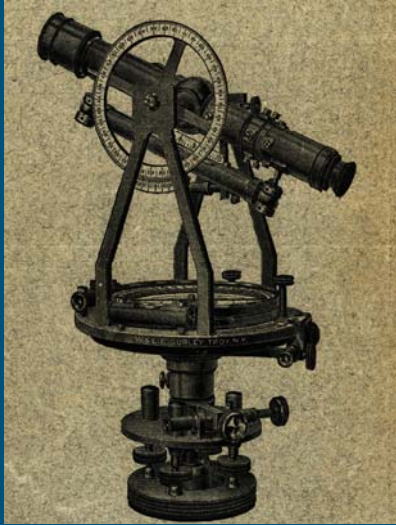

Visit us on the web: www.wsls-nec.org

CHAPTER MEETING

Thursday

January 10, 2019, 5:30PM

Swan Club

De Pere, WI 54115



Lisa Van Horn will be doing a presentation on NSPS.

TABLE OF CONTENTS

President’s Message	4
Meeting Location	5
General Meeting Agenda	6-7
General Members Mtg. Minutes	8-9
Student Meal Sponsor Information	10
2019 Membership Application	11
Treasurer’s Report	12-13
Paid Membership Report	15
Board of Director’s Meg. Minutes	16
Summer Meeting Pictures	17
Spring Survey Lab Pictures	18
Paid Member Roster	19-22

2018 MEETINGS, SCHEDULE & LOCATION

Winter General Meeting

Swan Club in De Pere

January 11, 2018 5:15 pm Social 6:00 pm Dinner/Mtg

Winter Board Meeting

Suster’s in Denmark

February 15, 2018 6pm Social 6:45pm Dinner/Mtg

Spring General Meeting

Rock Garden in Green Bay

April 12, 2018 6pm Social 6:45 pm Dinner/Mtg

Spring Board Meeting

Titletown in Green Bay

May 17, 2018 6pm Social 6:45 pm Dinner/Mtg

Summer Golf/Trap Outing

Wander Springs in Greenleaf

July 19, 2018 6pm Social 6:45 pm Dinner/Mtg

Summer Board Meeting

Brickhouse in De Pere

August 16, 2018 6 pm Social 6:45 pm Dinner/Mtg

Fall General Meeting

Liberty Hall in Kimberly

October 11, 2018 6pm Social 6:45pm Dinner/Mtg

Fall Board Meeting

Mackinaws in Green Bay

November 15, 2018 6pm Social 6:45pm Dinner/Mtg

Winter General Meeting

Swan Club in De Pere

January 10, 2019 5:00pm Social 5:30pm Dinner/Mtg

**Newsletter
Online?**

**Chapter newsletter online
update.....**

The electronic version of the newsletter has been working great. Please let me know if any questions arise.

The website is up and in working order. Currently we have 98% of our members receiving the newsletter by e-mail . If you would like to sign up for the electronic newsletter email me at

bostedtj@ayresassociates.com

Visit us at - www.wsls-nec.org

Jill Bostedt - Newsletter Editor

bostedtj@ayresassociates.com

2018 WSLs OFFICERS:

- Robert Beilfuss
President
- Lisa Van Horn
NSPS President Elect
- Jim Sehloff
WSLS Representative

2018 Chapter Representatives

President - Andy Cleveland - 920-639-6908

President Elect - Ryan Duckart - 920-448-4494

Director - Brad Nelson—920-467-2655

Past President - Troy Hewitt—920-662-9641

Secretary\Treasurer - Tom Leslie - 920-448-4495

Newsletter Editor - Jill Bostedt - 920-327-7853

2018 NE CHAPTER COMMITTEES

AUDITING COMMITTEE

Chair: Terry Van Hout (448-4493)
Brad Nelson

VanHout_TL@co.brown.wi.us

CST COMMITTEE

Chair: Zach Solberg (740-6081)
Lisa Van Horn

zsolberg@coleman-engineering.com

ETHICS & PRACTICE COMMITTEE

Chair: Tom Leslie (448-4495)
Andy Cleveland
Steve Zeitler
Tony Lulloff

Leslie_tl@co.brown.wi.us

LAND RECORDS COMMITTEE

Chair: Jason Bolz (448-7655)

Bolz_JD@co.brown.wi.us

LEGISLATIVE COMMITTEE

Chair: Ed Harvey (459-3822)

harveelh@co.sheboygan.wi.us

MEMBERSHIP COMMITTEE

Chair: Scott DeBaker (662-9641)
Bob Reider

sdebaker@releinc.com

NOMINATING COMMITTEE

Chair: Joel Wald (830-8184)
Larry Miller

joel.wald@omni.com

PROGRAM COMMITTEE

Chair: Andy Cleveland (569-5765)

acleveland@mach-iv.com

PUBLIC RELATIONS COMMITTEE

Chair: Aaron Ballast (680-8261)
Lisa Van Horn

tnt-pls@tntsurveyors.com

SCHOLARSHIP COMMITTEE

Chair: Tom Leslie (448-4495)
Troy Hewitt
Jim Sehloff

Leslie_tl@co.brown.wi.us

SEMINAR COMMITTEE

Chair: Terry Van Hout (448-4493)
Jim Wallen
Tom Leslie

vanhout_tl@co.brown.wi.us

STUDENT CHAPTER COMMITTEE

Chair: Justin Smith-Herter (949-584-1080)

justin.smithherter@gmail.com

TRIG*STAR COMMITTEE

Chair: Ryan Duckart (448-4494)

Duckart_RL@co.brown.wi.us

PHOTOGRAPHER

Lisa Van Horn (360-1812)

Leslisa13@att.net

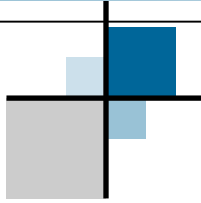

PRESIDENT'S MESSAGE:

Presidents Message:

Happy New Year Northeast Chapter!

It has been a lot of fun being the President of the Northeast Chapter this past year! I think my biggest accomplishment is not having the gavel broken over my head! (I used it quite a bit at staff meetings throughout the year) I would like to say thank you to all of the committee members, board members, and everyone else that has helped me out!

We truly have an amazing Chapter due to the people who make up the membership. When I was first approached about serving on the board, I was hesitant and concerned about how much time it would consume. What I did not realize is that I was stepping into a well-organized system that is truly about the efforts of the many. I cannot compliment the people who have helped shape our Chapter enough. What an amazing job you have all done!

At our January 10th general meeting, I would encourage all who have not had the pleasure to be a part of the Board, or a committee to sign up. The reward is significantly greater than the effort you will put forth.

I also wish our next President, Ryan Duckart, good luck, as I will try and be the light of inspiration that Troy Hewitt was to me!

I look forward to seeing you on the 10th!

Andrew S. Cleveland, PLS
Northeast Chapter President

~ GENERAL MEMBERSHIP MEETING ~

The Northeast Wisconsin Chapter of the Wisconsin Society of Land Surveyors

Attitude adjustment is at 5:00 pm and Dinner is at 5:30 pm Dinner will cost \$20.00

If you plan on attending the meeting please RSVP so we can get an accurate count for the meal.

Tom Leslie Secretary/Treasurer (920)448-4495 leslie_tl@co.brown.wi.us

Andy Cleveland President (920) 639-6908 andycleveland@att.net

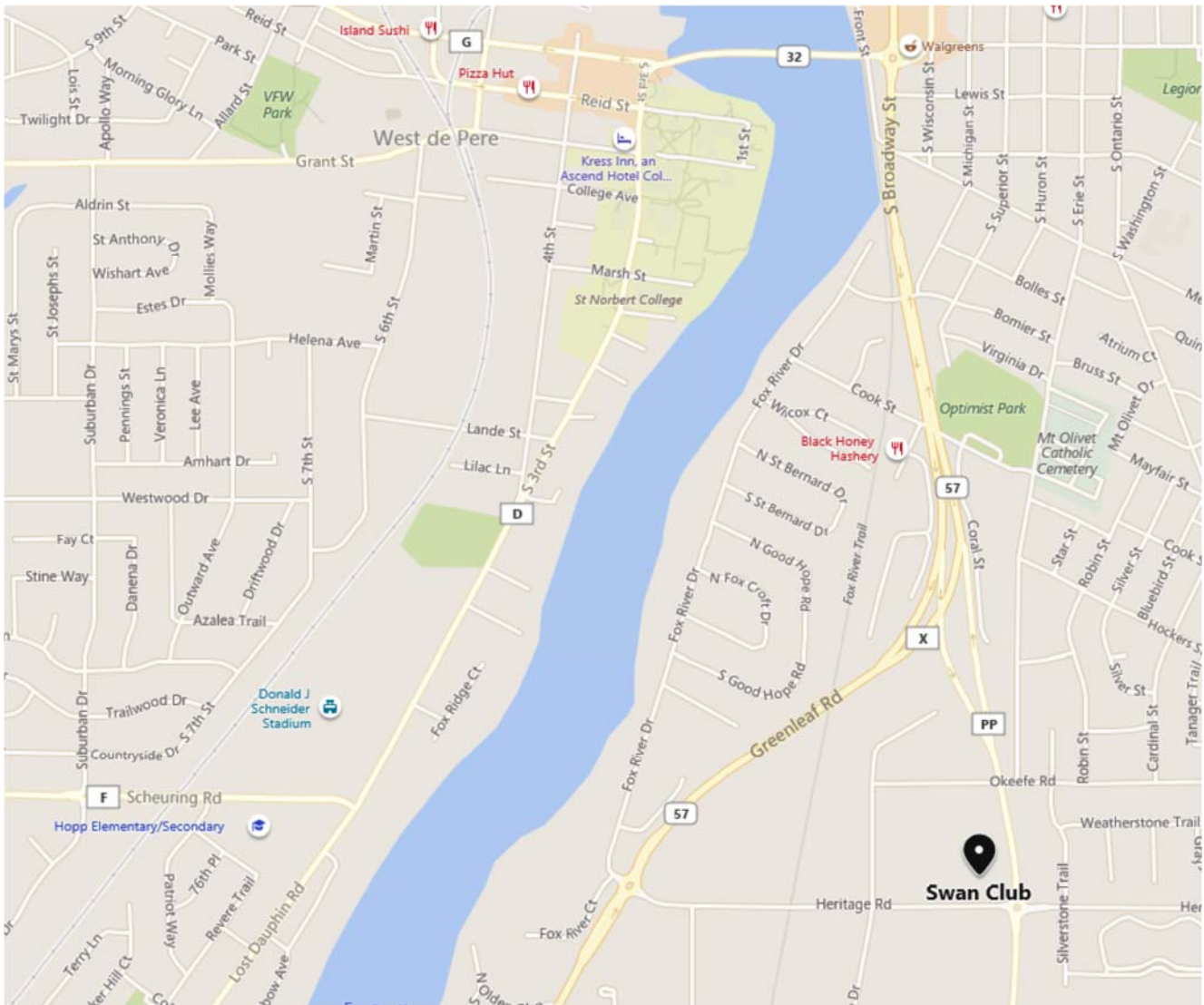

Swan Club
875 Heritage Road De Pere, WI



Northeast Wisconsin Chapter OF THE Wisconsin Society of Land Surveyors



General Meeting Agenda

1-10-19 | 5:00pm | Meeting location *Swan Club in De Pere*

President	Andy Cleveland
President Elect	Ryan Duckart
Past President	Troy Hewitt
Director	Brad Nelson
Secretary/Treasurer	Tom Leslie
NE Chapter Rep	Jim Sehloff

AGENDA TOPICS

CALL THE MEETING TO ORDER	
ADDITIONS TO THE AGENDA	
APPROVE THE MINUTES FROM THE 2018 FALL GENERAL MEETING	
APPROVE THE TREASURER'S REPORT	Tom Leslie
NEWSLETTER EDITOR'S REPORT	Jill Bostedt
WLS REPORT	Jim Sehloff
NSPS REPORT	Lisa Van Horn

COMMITTEE REPORTS

Auditing Committee	Terry Van Hout
Business:	
CST Committee	Zachary Solberg
Business:	
Ethics and Practices Committee	Tom Leslie
Business:	
Land Records Committee	Jason Bolz
Business:	
Legislative Committee	Ed Harvey

COMMITTEE REPORTS

Business:

Membership Committee

Scott DeBaker

Business:

Nominating Committee

Joel Wald

Business:

Program Committee

Andy Cleveland

Business:

Public Relations Committee

Aaron Ballast

Business:

Scholarship Committee

Tom Leslie

Business:

Seminar Committee

Terry Van Hout

Business:

Student Chapter Committee

Justin Smith-Herter

Business:

Trig Star Committee

Ryan Duckart

Business:

OLD BUSINESS

NEW BUSINESS

Committee sign up sheets.

Any other new business?

Adjourn



Northeast Wisconsin Chapter of WSLs

2018 FALL GENERAL MEETING MINUTES

October 18, 2018 – Liberty Hall in Kimberly, WI

The 2018 Fall General Meeting was held on October 19, 2018 at Comfort Suites in Green Bay, WI. There were 65 members present, including 33 students, when Chapter President Andy Cleveland introduced:

Presentation

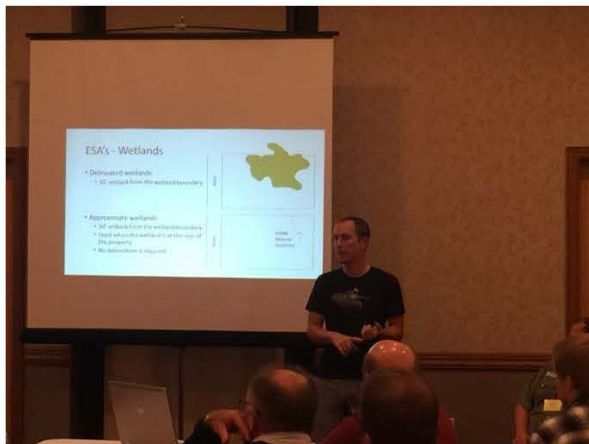

Dan Teaters, Brown County, discussed ESA issues and the different ways that these issues can be handled.

Discussion included:

- Water Quality Plan requirements
- What constitutes an ESA? Wetlands, waterways, floodplains/floodways, steep slopes, others
- Brown County's role including BC Sewage Plan, sanitary sewer service areas, defining ESAs
- Federal Clean Water Act (Section 208)

President Cleveland thanked Dan for his informative presentation

President Cleveland then called the General Meeting to order at 7:41 pm

Due to an organizational moving issue, I cannot locate the usual meeting folder, in which are the minutes, notes and other items, so, unfortunately, there are no Summer General Meeting minutes for July 19, 2018 held at Wander Springs Golf Course. I truly apologize for the error. Tom

A motion was made, seconded and approved to accept the Treasurer's Report as presented in the latest Chapter Newsletter

The following reports were given (* by email):

Newsletter Editors Report (Jill Bostedt)*

- No report at this time – all is going well

WSLS Report (Jim Sehloff)

- Last meeting was in Stevens Point
- Andy Cleveland has volunteered as Chair of WSLs Outreach Committee
- Digger's Hotline has remained a hot issue. If anyone has a complaint, please forward to Kevin Boyer
- WSLs will donate \$500 to the NWTN NSPS Team Challenge coming up in March 2019

NSPS Report (Lisa Van Horn)*

- No report - Lisa Van Horn and Terry Van Hout are in Washington DC are for National NSPS meeting

Auditing Committee (Terry Van Hout)*

- No report at this time

CST Committee (Zach Solberg)

- No report at this time

Ethics and Practices (Tom Leslie)

- No report at this time

Land Records (Jason Bolz)*

- No report at this time

Legislative (Ed Harvey)

- Election hangover – nothing happening right now

Membership (Scott DeBaker)*

- 33 Students introduced themselves
- Total Membership: **165**

Nominating Committee (Joel Wald)

- Just getting started – more info soon

Program Committee (Andy Cleveland)

- Thank you again to Dan Teaters from Brown County

Public Relations (Aaron Ballast)

- No report at this time

Scholarship Committee (Tom Leslie)

- Scholarships announcement will be going out to local schools in the next few days

Seminar Committee (Terry Van Hout)

- Topics are being worked out

Student Representative (Justin Smith-Herter)

- Students expressed their intention of returning to the next NSPS Team Competition, and hope the Chapter would continue their support
- *A motion was made, seconded and approved* to match last year's donation to the team (\$1000). Chapter Secretary will forward a check to the team

Trig Star (Ryan Duckart)

- Quiet time of the year right now
- Anyone interested in helping sponsor at a particular school, please contact Ryan and he can get you started

Old Business

- No "Old Business"

New Business

- Bob Reider spoke on the possibility of helping local Boy Scouts to achieve their Survey badge. There is an opportunity on May 18, 2019 at High Cliff State Park. Contact Bob for any further information
- Sign-up sheet is being passed around – please consider volunteering your time for this event
- Up to 150 scouts could be attending – more information will be shared at the next few meetings. Any equipment for use and/or display would be welcome

Chapter Free Meal: Mike Kaczmarzyk (donated to Student Meals)

Being no further business, *a motion was made, seconded and approved* to adjourn at 7:57pm.

Respectively Submitted,

Thomas Leslie
Secretary/Treasurer

The Northeast Chapter of the Wisconsin Society of Land Surveyors

2019 Sponsor A Student Meal Program

Sponsorships are for a free meal at any of the 4 Quarterly Northeast Chapter General Meetings. Any student or person interested in the profession is eligible. If you have someone that would like to participate, please bring him or her along to the next meeting.

Thank you to all who participated in the past 12 years, it has been a HUGE success!

We are again asking for your support in sponsoring student meals in 2018 and beyond. Your donation will encourage students (and potential employees) to take an interest in the surveying industry and perhaps Chapter involvement.

-- Please fill out form below as you would like to be acknowledged for your free meal donation --

Date: _____

Name: _____

Company: _____

Phone Number: (H) _____ (W) _____ (Fax) _____

Email: _____

Sponsorship Fee: \$20.00 per meal

- I/We would like to sponsor _____ student meals (meals x \$20.00)... \$ _____

Make checks payable to: The Northeast Chapter of WSLS
Return to: Tom Leslie - Secretary/Treasurer
1951 Andraya Lane
De Pere, WI 54115

2019 Northeast Wisconsin Chapter of WSLs MEMBERSHIP APPLICATION

Name: _____ Registration Number: _____

Mailing Address: _____

Place of Work: _____ Work Phone: _____ Cell: _____

Email: _____ OK to Publish? Yes _____ No _____

Signature: _____ Date: _____

MEMBERSHIP DUES

- () **Professional Member**
\$40.00 Any person currently registered as a Land Surveyor in the State of Wisconsin
- () **Affiliate Member**
\$20.00 Any person not registered, who is interested in land surveying
- () **Life Member**
No dues Any person having reached the age of 65, retired from practice, having been a member for two years prior to the date of retirement, having been recommended by a member and application approved by the Board of Directors
- () **Student Member**
\$10.00 Any person currently enrolled in a surveying curriculum
- () **Sustaining Member**
\$80.00 _____ Any commercial or professional institution or individuals interested or affiliated with the surveying profession
Membership includes a display of their business card in Quarterly newsletter and on website
- \$120.00 _____ Membership includes a **full** page ad, display of their business card in quarterly newsletter and on the website

MAKE CHECKS PAYABLE TO: "THE NORTHEAST CHAPTER OF WSLs"

Return application and dues to: Tom Leslie 1951 Andraya Lane De Pere, WI 54115

Northeast Wisconsin Chapter

OF THE

Wisconsin Society of Land Surveyors

TREASURER'S REPORT

December 31, 2018

Checking Account

Starting Balance 1-1-18 13,457.53*

Deposits

1-23-18	Winter Gen Mtg	3630.00	
3-19-18	Dues	1220.00	
3-26-18	Seminar	3450.00	
5-25-18	Spring Mtg	865.00	
6-7-18	Spring Dues	480.00	
12-31-18	Summer/Fall Mtgs	1420.00	

+ 11,065.00

Checks

Chapter Scholarship	2496	750.00	
Chapter Scholarship	2497	750.00	
Newsletter Editor fee	2498	400.00	
Secretary/Treasurer fee	2499	600.00	
Supplies/Badges	2500	168.39	
Winter Meeting-Swan Club	2501	1,213.11	
Appleton Trophy	2502	78.75	
WSLS Foundation donation	2503	1,000.00	
Chapter Bucky's Team-Institute	2504	250.00	
VOID	2505	0.00	
NWTC Vegas Team donation	2507	1,000.00	
Comfort Suites-Seminar venue/meal	2508	1,028.40	
Comfort Suites-Spring General Mtg	2509	1,417.92	
Appleton Trophy-Lifetime plqs	2510	206.85	
Appleton Trophy-Lifetime plq	2511	80.85	
Trig Star costs/prizes	2512	305.60	
Wander Springs-Summer Gen Mtg	2513	587.39	
Scott DeBaker-Website Host dues	2514	395.64	
Service Charge		9.10	

-10,242.00

Outstanding Checks

Marathon County 45/90 donation	2491	2,000.00	
WSLS Foundation (CST test donation)	2506	450.00	
Liberty Hall – Fall General Meeting	2515	1,376.77	
NWTC NSPS Team Competition	2516	1,000.00	
		(4,826.77)	

Chapter Checking Acct:	*14,280.53
<i>(* - Checking Acct contains \$360 for donated student meals)</i>	<u>- 360.00</u>

***Available Chapter Funds:* 13,920.53**

6-Month Certificate of Deposit

Last Maturity Balance	11-5-18	2,233.41
Current Interest Rate (0.90%)	<i>Next Maturity Date: 5-7-19</i>	

TOTAL ASSETS: \$16,153.94

TOTAL ASSETS (after outstanding cashed) \$11,327.17

*Winter 2019 General Meeting
Tom Leslie
Northeast Chapter Treasurer*

Seiler Instrument

Your Source For...

Seventy years ago our firm started with Optics by servicing and reconditioning surveying instruments and microscopes. Over the years Seiler Instrument focused on expanding this technology to Surveyors and many other industry professionals to support, promote, and educate our customers initially on GPS now better known as GNSS technology, along with 3D Laser Scanning, UAV technology, GIS/CAD software and more.

Seiler is an authorized distributor and partner with many high quality American Manufacturers such as:

- Trimble / Spectra Precision/ Seco
- Esri
- Seafloor Systems
- AGL
- Autodesk
- Optimal Ranging
- Intuicom
- Laser Technology

Seiler Instrument's continued commitment to customer service excellence goes beyond just a sale. We support industry professionals with experienced field and service staff that meet your needs face-to-face. Our dedication to continuing education through local surveying and industry associations further support and strengthen our commitment to you – our customer.

Thank you for your business and the opportunity to earn it.

70 YEARS OF EXCELLENCE
1945-2015



Toll Free: 888-263-8918
solutions@seilerinst.com
www.seilerinst.com

Contact Us:

Seiler Instrument Wisconsin Office
9755 Airways Court
Franklin, WI 53132
Office: 414-423-0780
or
Terry Lueschow – (920) 980-7585
Holly Urbain – (608) 279-1007
Jim Nelson - (414) 322-9801



Northeast Wisconsin Chapter
 OF THE
Wisconsin Society of Land Surveyors

PAID MEMBERSHIP
 As of December 31, 2018

PROFESSIONAL	78
AFFILIATE	24
STUDENT	35
SUSTAINING	4
LIFETIME	<u>24</u>
TOTAL	165



Northeast Wisconsin Chapter of WSLs

2018 FALL BOARD OF DIRECTORS MEETING November 15, 2018 – Out O’ Town Club in Kaukauna, WI

There were 7 members present when President Andy Cleveland called the meeting to order at 6:40 pm

Due to unfortunate moving “accident”, there are no minutes from the Summer Board Meeting on August 16, 2018 at the Brickhouse Pub in De Pere, WI

Treasurer’s Report was accepted as presented in latest newsletter (no changes)

The following reports were given: (* via email)

NEWSLETTER EDITOR REPORT (Jill Bostedt)*

- No report at this time

WSLS REPORT (Jim Schloff)

- Next meeting on December 2, 2018. Budget will be discussed as well as voting for Institute awards

NSPS REPORT (Lisa Van Horn)*

- Appears NSPS dues will be raised for 2019. The amount is probably \$10. Not sure on what WSLs will do – absorb the increase or pass at least part of it to the members

AUDITING (Terry Van Hout)*

- No report at this time

CST (Zach Solberg)*

- CST testing is planned for the upcoming Institute

ETHICS AND PRACTICE (Tom Leslie)

- No report at this time

LAND RECORDS (Jason Bolz)*

- No report at this time

LEGISLATIVE (Ed Harvey)*

- Election hangover – nothing happening right now

MEMBERSHIP (Scott DeBaker)*

- There are 167 paid members as of this meeting

NOMINATING (Joel Wald)*

- Working on a list of nominees
- Secretary will forward database to Joel

PROGRAM (Andy Cleveland)

- Nothing planned yet for Winter General meeting

PUBLIC RELATIONS (Aaron Ballast)*

- Poster from WSLs (below) can be distributed to whatever program/event in need of surveying items



SCHOLARSHIP (Tom Leslie)

- School have been notified and applications are due back on December 1st, 2018
- Committee will process applications, contact the winners and handle meeting presentations

SEMINAR (Terry Van Hout)*

- Still working on specifics

STUDENT REPRESENTATIVE (Justin Smith-Herter)

- NSPS Team competition donation?

TRIG*STAR COMMITTEE (Ryan Duckart)

- Denmark, Two Rivers and possibly Bay Port & Oconto will participate in 2019

OLD BUSINESS

- No “Old Business” to discuss

NEW BUSINESS

- Raffle will return at the Winter General Meeting, with Joel Ward presiding – thank you!

Being no further business *a motion was made, seconded and approved* to adjourn at 7:27 PM

Respectively submitted,

Tom Leslie
Secretary - Fall 2018 Board Meeting

PICS FROM SUMMER MTG 2018

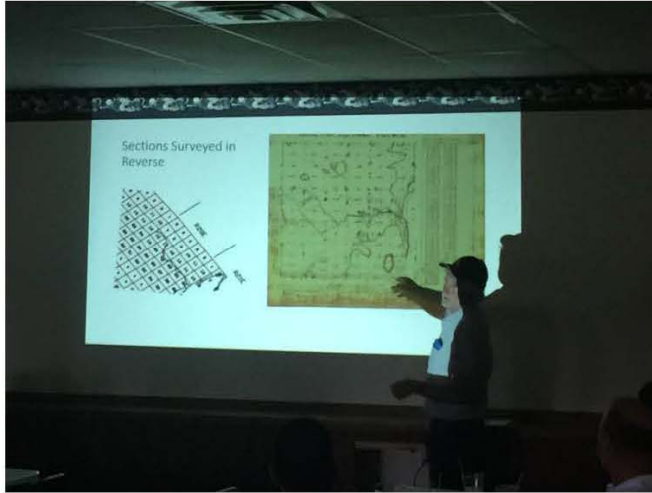

LES VAN HORN presenting on the 3 Mile Method for Breaking Down a Section in the Oneida Indian Reservation

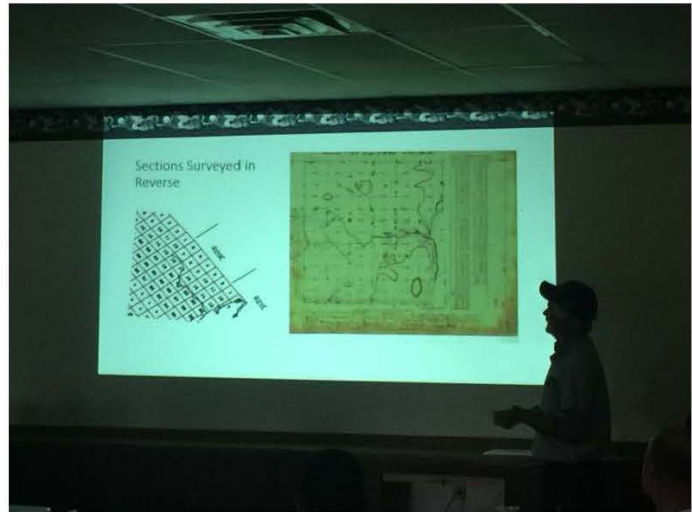

July 19, 2018
Wander Springs Golf Course
Wayside, Wisconsin

2018 SPRING SURVEY LAB



LES VAN HORN presented a survey lab letting today's surveyors run a survey using old time equipment



April 14, 2018

Brown County Golf Course

Hobart, Wisconsin



2018 Members

1/4/2019

Email	PD	ID#	Last Name	First Name	Email Address
y	x	559	Andersen	Scott	scott@davel.pro
Y	x	221	Ballast	Aaron	tnt-pls@tntsurveyors.com
Y	x	40	Baudhuin	John	hudbaudhuin@gmail.com
Y	x	537	Beltrand	Ryan	beltrandr@ayresassociates.com
Y	x	627	Berken	Cheryl	cheryl.berken@co.brown.wi.us
Y	x	59	Bieda	Steven	sbieda@mau-associates.com
Y	x	61	Blatchford	Larry	bdlpond@gmail.com
Y	x	567	Blondheim	Jim	jblondheim@coleman-engineering.co
Y	x	591	Bolz	Jason	jasonbolz20@gmail.com
Y	x	490	Born	Michael	michael.born@sheboyganwi.gov
Y	x	476	Bostedt	Jill	BostedtJ@AyresAssociates.com
Y	x	626	Boyer	Kevin	kboyer@emcsinc.com
Y	x	487	Braun	Jacob	jacobraun17@yahoo.com
Y	x	429	Buechel	Bradley	bbuechel@meridian-wi.com
Y	x	536	Cappeart	James	cappeartj@ayresassociates.com
Y	x	193	Charlier	Harold	hcharlier@wi.rr.com
Y	x	62	Chrouser	David	dchrouser@mau-associates.com
Y	x	296	Clark	Robert	robert.clarkiii3@gmail.com
Y	x	168	Cleary	Christopher	chrisc@martenson-eisele.com
Y	x	344	Cleveland	Andy	andycleveland@att.net
Y	x	28	DeBaker	Scott	sdebaker@releeinc.com
Y	x	342	DeJong	Steve	sdejong@meridian-wi.com
Y	x	628	DesRochers	Rebecca	rebecca.desrochers@aecom.com
Y	x	12	DeZeeuw	Jeffrey	jdezeeuw@acebuildingservice.com
Y	x	114	Duckart	Ryan	duckart_RL@co.brown.wi.us
Y	x	97	Eisele	David	davesjoy3@frontiernet.net
Y	x	66	Fogarty	Thomas	tfogarty@new.rr.com
Y	x	33	Ford	Patrick	pfordbike@aol.com
Y	x	543	Frisque	Doug	doug.frisque@tetrattech.com
Y	x	374	Frisque	Brian	brianfrisquesurveysinc@gmail.com
Y	x	50	Giese	Thomas	tomgi@greenbaywi.gov
Y	x	24	Gross	Brian	brian.gross@co.oconto.wi.us
Y	x	110	Guy Jr.	Hugh	hguy@centurytel.net
Y	x	6	Halverson	Thomas	pls1445@new.rr.com
Y	x	67	Harris	Robert	rharris@harrisinc.net
Y	x	68	Harvey	Edgar	ed.harvey@sheboygancounty.com
Y	x	228	Hebert	James	jim@hebertassoc.com
Y	x	11	Hebert	David	dave@hebertassoc.com
Y	x	375	Herrild III	Howard	howard.herrild@nwtc.edu
Y	x	215	Hewitt	Troy	thewitt@releeinc.com
Y	x	555	Hildebrand	Jeremy	jeremy.hildebrand@sheboygancounty
Y	x	630	Hilgart	David	dave2unit@gmail.com



Email	PD	ID#	Last Name	First Name	Email Address
Y	x	69	Hoel	Daniel	
Y	x	57	Hojan	Gene	gfhojan@gmail.com
Y	x	475	Huxford	Richard	wasesdas937@gmail.com
Y	x	396	Ingram	Jason	ingramj@ayresassociates.com
Y	x	267	Inman	Jeffrey Kip	kipinmants@att.net
N	x	133	Johanning	Robert	
Y	x	116	Johnson	Marty	marty.johnson@aecom.com
Y	x	427	Johnson	Robert	jlssurveyors@outlook.com
Y	x	71	Kaczmarzyk	Michael	mike.kaczmarzyk@omni.com
Y	x	486	Kaczmarzyk	Anthony	tony.kaczmarzyk@omni.com
Y	x	512	Kalkofen	Corey	ckalkofen@mcmgrp.com
Y	x	560	Kamin	Mark	mkamin@coleman-engineering.com
Y	x	4	Keach	Craig	ckeach@meridian-wi.com
Y	x	534	Kelliher	Shane	skelliher@mcmgrp.com
Y	x	295	Keyzer	Dennis	Keyzerd@gmail.com
Y	x	621	Klarnner	Ryan	klarnerr@ayresassociates.com
Y	x	127	Kolar	Chatfield	cpkolar@gmail.com
Y	x	523	Kostichka	Travis	tkostichka@releeinc.com
Y	x	568	Kromm	Thomas	tom.kromm@appleton.org
Y	x	372	Kruger	Kurt	kkruiger@kapur-assoc.com
Y	x	517	La Count	Donald	dlacount3@new.rr.com
Y	x	450	La Count	Benjamin	ben@evergreenwis.com
Y	x	105	Laning	A. Roger	rlaning@msn.com
Y	x	511	Ledvina	Travis	tledvina@releeinc.com
Y	x	451	Leica Geosystems	Bob Kilburn	bob.kilburn@leicaus.com
Y	x	20	Leslie	Thomas	leslie_tl@co.brown.wi.us
Y	x	22	Lett, Jr.	Joseph	jwlett2@wisconsinpublicservice.com
Y	x	508	Lindquist	Nicholas	nlindquist@mach-iv.com
Y	x	571	Loberger	Randy	randyloberger@aol.com
Y	x	293	Locy	Craig	gb3632@aol.com
Y	x	254	Lulloff	Anthony	aplulloff@gmail.com
Y	x	443	Mande	Jordan	jmande@tntsurveyors.com
Y	x	60	Mau	David	dmau64@gmail.com
Y	x	209	Mayer	James	jmayer8@new.rr.com
Y	x	10	Miller	Larry	ldmiller18@hotmail.com
Y	x	218	Nelson	Brad	bnelson@coleman-engineering.com
Y	x	390	Nordwig	Paul	paul.nordwig@omni.com
Y	x	173	Oettinger	Randall	roettinger@mach-iv.com
Y	x	540	Oshefsky	Lucas	loshefsk@gmail.com
Y	x	596	Peot	Brian	brian.peot@yahoo.com
Y	x	561	Perreault	Christopher	chris_p@carowlandsurveying.com
N	x	134	Petersen	Elton	

Email	PD	ID#	Last Name	First Name	Email Address
Y	x	563	Peterson	Andrew	apeterson@coleman-engineering.com
Y	x	217	Pfeffer	Bryan	bpfeffer@releeinc.com
Y	x	595	Pfister	Andrew	andy@davel.pro
Y	x	507	Pipes N Sticks	Chester Nowaczyk	polishinn@frontier.com
Y	x	545	Pries	Casey	cpries@coleman-engineering.com
Y	x	94	Raisleger	Dale	raisleger_de@co.brown.wi.us
Y	x	186	Rayford	Colin	crayfordd@sbcglobal.net
Y	x	594	Reenders	BJ	bjreenders@cedarcreeksurveying.com
Y	x	5	Reider	Bob	bob_r@carowlandsurveying.com
Y	x	590	Reider	Matthew	matt_r@carowlandsurveying.com
Y	x	27	Reim	Dennis	dreim@releeinc.com
Y	X	297	Rentmeester	Kory	kjrentmeester@integrysgroup.com
Y	x	137	Roach	Mike	mrsurveyor@sbcglobal.net
Y	x	510	Roubal	Michael	mlroubal@charter.net
Y	x	629	Rynish	Jordan	jrynish@releeinc.com
Y	x	491	Schertz	Kolby	kolby.schertz@questllc.biz
Y	x	424	Schmalz	David	dschmalz@mcmgrp.com
Y	x	622	Schmidt	Tony	schmidtt@ayresassociates.com
Y	x	141	Sehloff	James	jim@davel.pro
Y	x	52	Seiler Instruments	Terry Lueschow	tlueschow@seilerinst.com
Y	x	549	Sleik	John	jsleik@coleman-engineering.com
Y	x	55	Smith	Jim	jims@martenson-eisele.com
Y	x	547	Solberg	Zachary	zsolberg@coleman-engineering.com
Y	x	593	Stevens	Zak	stevenssurveying@gmail.com
Y	x	44	Telfer	Lee	151hobby@gmail.com
Y	x	535	Teska	Dean	dteska@kapurinc.com
Y	x	2	Teuteberg	Mark	
Y	x	76	Tilly	Raymond	
Y	x	471	Tilly	Alan	al_tilly@windstream.net
Y	x	1	Van Horn	Les	lesvh@att.net
Y	x	292	Van Horn	Lisa	leslisa13@att.net
Y	x	64	Van Hout	Terry	vanhout_tl@co.brown.wi.us
Y	x	473	Vande Hei	Mike	mvandehei001@new.rr.com
Y	x	79	VanGoethem	Rick	rvangoethem@yahoo.com
Y	x	169	Wald	Joel	joel.wald@omni.com
Y	x	80	Walenski	Keith	kwalenski@harrisinc.net
Y	x	592	Walenski	Garret	gwalenski@harrisinc.net
Y	x	32	Wallen	James	jkwallen@att.net
N	x	139	Watermolen	Bernard	
Y	x	489	Wegner	Brandon	bwegner@mach-iv.com
Y	x	25	Westerman	James	jwesterman@releeinc.com
Y	x	525	Wiley	Jesse	jpwiley8@gmail.com

Email	PD	ID#	Last Name	First Name	Email Address
N	x	492	Winter Wood Products	Nancy Winter	
Y	x	420	Woelz	Doug	dwoelz@mcmgrp.com
Y	x	81	Wolf	Ken	ken.wolf@tds.net
Y	x	513	Yurk	David	dave.yurk@omni.com
Y	x	83	Zahringer	Gary A.	garyz@martenson-eisele.com
Y		539	Anderson	Howard	handerson@mcmgrp.com
Y		394	Andraschko	Michael	mandraschko@mau-associates.com
Y		346	Blue Print Service Co Inc.	Gregory Pepin	gpepin@blueprints-service.com
Y		564	Conger	Taylor	tbecker217@gmail.com
Y		544	Freiberg	Jake	jfreiberg@fdl.wi.gov
Y		456	Frisque	Ryan	ryan.frisque@meadhunt.com
Y		546	Fulton	Nick	nfulton@fdl.wi.gov
Y		519	GAT Supply Inc	Deborah Gierczak	sales@gatsupply.com
Y		115	Gonnering	Michael	mike.gonnering@aecom.com
Y		321	Grzeskowiak	Kelly	klgrz220@yahoo.com
Y		430	Hansen	Alan	alsurveys@aol.com
Y		515	Hoffman	Michael	mhoffman04@yahoo.com
Y		415	Jensen	Jake	jensenj@ayresassociates.com
Y		518	Johnson	David	dave.johnson@outagamie.org
Y		391	Kuen	Peter	peter.kuen@fdlco.wi.gov
Y		493	LaBlonde	Dustin	dustin.lablonde@cedarcorp.com
Y		403	Lotto	Brett	lotto@fvtc.edu
Y		43	McCarty	Michael	mmccarty@baudhuin.com
Y		562	Melchert	Lyman	ljmelch@yahoo.com
Y		516	Merten	Rob	rob@hebertassoc.com
Y		538	Motquin	Jon	
Y		214	Olson	Jay	jolson@releeinc.com
Y		529	Roulette	Steven	steveroulette37@gmail.com
Y		570	Schuette	William	wschuette@new.rr.com
Y		373	Seiler Instruments	Steve Grady	tlemoine@seilerinst.com
Y		93	Seiler Instruments	Jim Nelson	jnelson@seilerinst.com
Y		557	Selle	David	dave.selle@gmail.com
Y		509	Thiry	Tyler	tyler@davel.pro
Y		377	Van Calster	Scott	svancalster92@gmail.com
Y		39	Weber	Aric	arweber@baudhuin.com
Y		82	Wood	Thomas	twood@harrisinc.net
Y		84	Zeitler	Steven	zeitler99@aol.com



SUSTAINING MEMBERS

Terry Lueschow, RLS
Trimble Sales Specialist

9755 Airways Court
Franklin, WI 53132
Toll Free: 877-444-6515
Direct: 920-451-8686
Fax: 920-451-8696
Email: tlueschow@seilerinst.com



Pipe 'N Sticks
9001 Stewart Ave
Wausau, WI 54401

*Central Wisconsin's supplier
of lathes, hubs, iron pipe and
iron bars since 1988*

Contact Chet or Pam Nowaczyk

Phone: 715-848-1961 E-mail: polishinn@frontier.com



- when it has to be right **Leica**
Geosystems

Bob Kilburn
Geomatics Sales & Support

Leica Geosystems, Inc
Part of Hexagon

M: +1.920.716.8016

bob.kilburn@leicaus.com
www.leica-geosystems.us

**THE NORTHEAST WISCONSIN
CHAPTER OF THE
WISCONSIN SOCIETY OF
LAND SURVEYORS**

NEWSLETTER EDITOR

Jill Bostedt
Ayres Associates
3376 Packerland Drive
Ashwaubenon, WI 54115
920-327-7853
E-Mail: bostedtj@ayresassociates.com



WINTER WOOD PRODUCTS

Bryan or Nancy Winter
6220 Nero Drive
Sobieski, WI 54171
(920) 822-8143

WISLS Member

Laths, Hubs, Stakes,
Paint, Roll Flagging
& Whiskers